

Pre-Blended Portland Cement Thick Bed Mortar

DS.DM. 061620

PRODUCTS

- Deck Mud - Poly ☐
- Deck Mud - Plus ☐
- Deck Mud ☐
- 2:1 ☐ - 3:1 ☐ - 4:1 ☐

MANUFACTURER

ORCO Blended Products
27347 3rd St. Highland, CA 92346
877-838-6726 Fax 909-862-2490
www.orco.com



DESCRIPTION

OBP Deck Mud-Poly, Deck Mud-Plus and Deck Mud are dry, factory blended mortars designed to produce high strength, thick, leveling mortar beds. All products are available in standard mix designs and special order formulas to meet individual project requirements. Deck Mud is not a bonding mortar - use appropriate VBM mortar for bonding.

Deck Mud-Poly- has added polymers providing additional flexural strength, water repellent properties and efflorescence protection for the most demanding applications.

Deck Mud-Plus-is a high strength, sand and cement mix that includes an integral water repellent. The water repellent properties protect the installed paver system of water migration from the substrate. This provides efflorescence protection and protection for the bonding system. An economical water repellent mortar bed.

Deck Mud-is a blend of cement and sand. Standard and customs mix designs available.

Efflorescence: Deck Mud-Plus and Poly reduce the potential of efflorescence due to their water repellent properties, however, due to variables beyond our control, we cannot guarantee efflorescence will not occur.

USES

All 3 products are used as a thick bed mortar underlayment for all types of pavers, tile, stone and marble. It is used on floors, counter tops, driveways, patios, shower pans and anywhere a thick bed leveling mortar is specified. Poly or Plus should be used where efflorescence control/water repellent properties are desired. All products may be used as a setting bed mortar for exposed stone landscapes and similar applications.

ADVANTAGES

- High quality control
- Convenient - easy handling
- Efflorescence control (Deck Mud - Poly or Plus)
- Water repellent (Deck Mud - Poly or Plus)
- Added flexural strength (Deck Mud - Poly)
- Freeze thaw durable (Deck Mud - Poly or Plus)
- Bulk systems available

PACKAGING

Available in 75 lb. paper bags, 3000 lb. bulk bags. Information on bulk bag, and silo bulk system is available upon request. **SHELF LIFE:** When stored in a cool dry area, with low humidity, shelf life is approx. six months to one year.

COVERAGE

One 75 lb. bag will yield approximately .62 cubic feet.

LIMITATIONS

- Do not apply when temperatures are below 40°F prior to cure.
- Follow ANSI and ASTM guidelines in high heat, wind or cold.
- Follow current building codes and TCNA.
- Substrates must be sound - any cracks or excessive movement may telegraph through mortar or cause bond failure.
- Do not cover expansion or movement joints.
- Deck Mud is not a dry set bonding mortar. Use VBM Bonder, Poly VBM or other approved bonding mortar.
- Concrete must be well cured. 28 days recommended.

TECHNICAL DATA

Deck Mud products are a blend of Portland Cement (ASTM C150) and washed masonry sand (ASTM C144). Deck Mud-Plus contains an integral water repellent. Deck Mud-Poly contains additional polymers for added flexural strength and water repellent properties. Typical compressive strength test results for all products exceed 4000 psi when mixed at a dry pack consistency.

INSTALLATION

Substrate: The substrate must be structurally sound and conform to good engineering practices. Substrate deflection under all live, dead and impact loads, including concentrated loads must not exceed L/360 for thin bed installation or L/480 for thick bed stone installations, where L = span length. Installations shall be in accordance with IBC, ANSI, CBC, TCNA and local building codes. Movement joints shall be brought through mortar and veneer to the surface.

All surfaces must be sound, clean, and free from any dirt, oil, paint, bond breakers, efflorescence or any contaminants which may hinder bond.

Mixing: Add to enough potable water so the mortar will form a ball when compacted in your hand. Approximately 4 quarts per 75 lb. bag of mortar. Mix water may be adjusted to achieve the desired consistency, however, Deck Mud is designed to be placed in a dry pack consistency.

APPLICATION

Bonded installation: When bonding to the substrate, apply a slurry bond coat of VBM Bonder to the substrate just prior to installation (100% Coverage). While the VBM Bonder is still wet, place the Deck Mud into the slurry coat to the desired thickness, compact well and level. If the paver/tile is to be placed immediately, apply a slurry bond coat of VBM Bonder (100% coverage) to the paver/tile and place onto the damp Deck Mud. Beat into place. Periodically check installation to assure good contact and bond. If the Deck Mud leveling bed is allowed to dry prior to installation of the paver/tile, use the appropriate bonding mortar for the application.

Unbonded Installation: (Over cleavage membrane) Install cleavage membrane on the substrate as required. Apply approximately $\frac{1}{2}$ of the mortar depth of Deck Mud over the cleavage membrane. Place approved 16 gage galvanized welded wire mesh (2" x 2") (50mm x 50mm) into the mortar. Lap joint should be at least one full mesh. Apply the remaining Deck Mud, covering the wire mesh, level and compact well. The wire mesh should be in the middle of the mortar bed. The minimum thickness of the Deck Mud mortar bed shall be 2 inches (50mm). If the paver/tile is to be placed immediately, apply a slurry bond coat of VBM Bonder to the paver/tile (100% coverage) and beat into place.

If the Deck Mud leveling bed is allowed to dry and cure, use the appropriate bonding mortar for the installation. Always perform quality control test before and during application. Protect work in high heat, wind or cold. Follow ASTM/ANSI guidelines. Due to the many variables of substrate conditions and pavers, it is the responsibility of the user to assure the products and installation produces are suitable for the application. Allow a minimum of 24 hours cure for foot traffic and 72 hours for vehicle traffic.

Joint Grout/Pointing Mortars – MAC Mortars (course sand) or **VP Joint Grout** (fine aggregate) is recommended. Allow bonding mortars to fully set (minimum 24 hrs) prior to grouting to assure bond is not disturbed. These mortars also contain efflorescence reducing additives.

CLEAN-UP

Clean trowels and masonry units with water prior to hardening.

AVAILABILITY / TECHNICAL SERVICES

Contact ORCO Blended Products for dealers in your area and technical services at 877-838-6726.

CAUTION

Prolonged exposure to dust may cause delayed lung disease. Eliminate exposure to dust. Use NIOSH approved mask for silica dust. Freshly mixed materials may cause skin irritation. Avoid direct contact where possible and wash exposed skin areas promptly. If any cementitious materials get into the eyes, rinse immediately and repeatedly with water and get prompt medical attention. See SDS sheet.

Warning: This product can expose you to Silica, crystalline (airborne particles or respirable size) which is known to the State of California to cause cancer. For more information go to www.p65Warnings.ca.gov.

WARRANTY

The technical information and usage statements are based on our best knowledge. The contents of this specification sheet are presented for informational purposes only and do not constitute responsibility for their use. The manufacturer will replace only that material which is proven defective due to quality of the components or the manufacturing process.

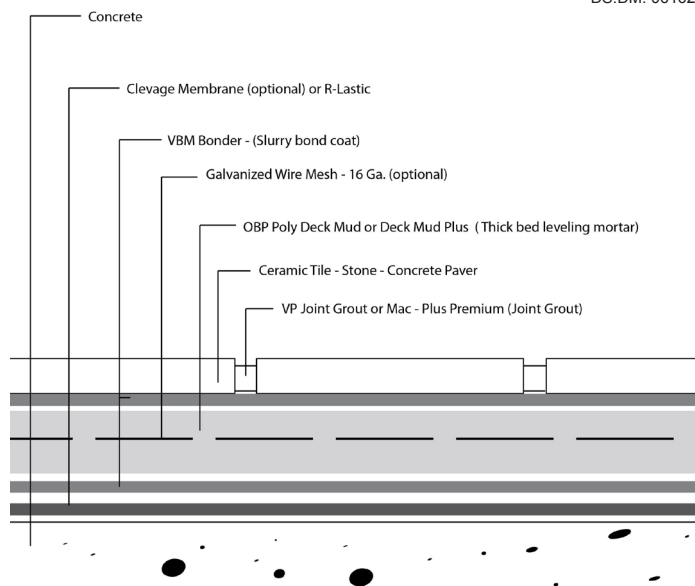

**PAVER INSTALLATION
THICK BED LEVELING MORTAR BED**



**DECK MUD - POLY WITH VBM BONDER SLURRY COAT.
GROUTED WITH VP JOINT GROUT PREMIUM**



COBBLE STONE INSTALLATION

PRODUCT DATA SHEETS ARE SUBJECT TO CHANGE WITHOUT NOTIFICATION. TEST RESULTS SHOWN ARE TYPICAL BUT FIELD PERFORMANCE WILL VARY DEPENDING ON INSTALLATION METHODS AND JOB CONDITIONS. *MAC AND VBM MORTARS ARE A TRADEMARK OF R-CRETE INC.