

# 7'-4" HIGH WALL SYSTEM SITE WALL SECTION THROUGH WALL BETWEEN CAISSONS

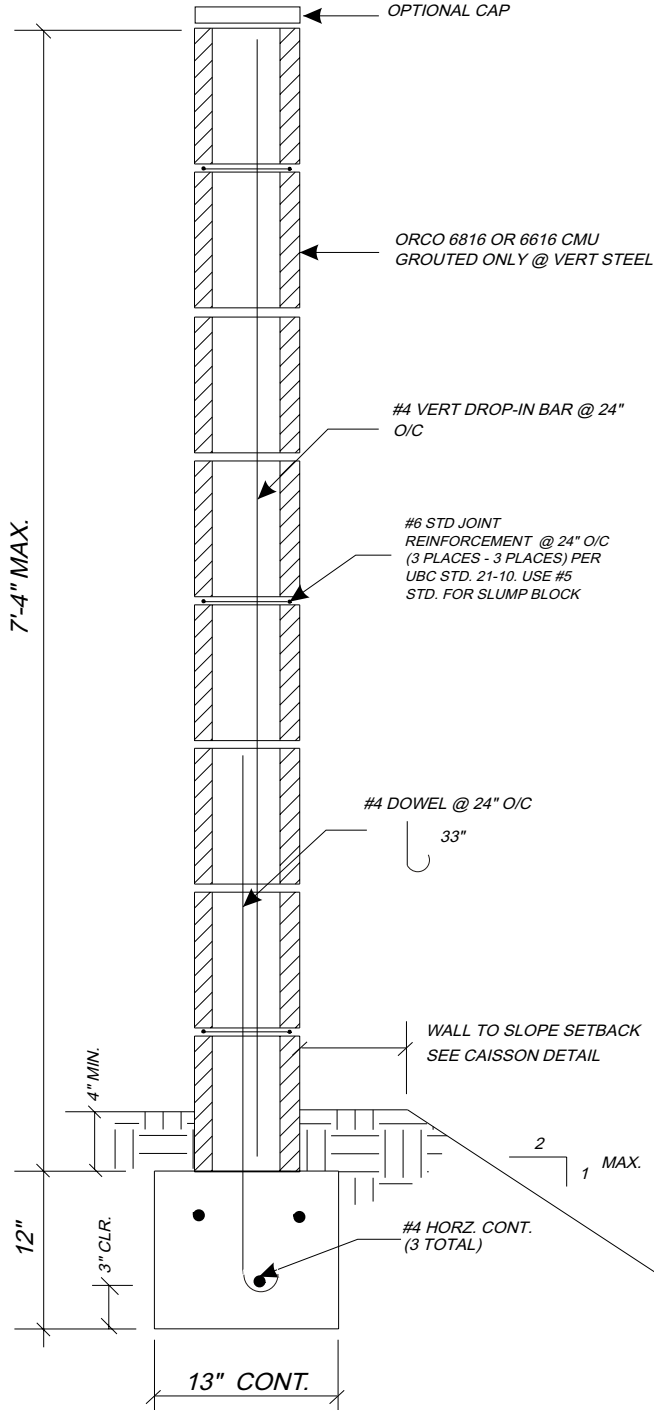

**DESIGN CRITERIA: FOR 70 MPH WIND @ EXP C**  
 1. ALLOWABLE SOIL BEARING PRESSURE = 1500 PSF  
 2. ALLOWABLE LATERAL PASSIVE PRESSURE = 250 PCF  
 3. GROUT STRENGTH = 2000 PSI @ 28 DAYS.  
 4. REINFORCING STEEL : GRADE 40 FOR #4 BARS AND SMALLER & GRADE 60 FOR #5 AND LARGER  
 5. SEISMIC - ZONE 4, 10 KM FROM TYPE B SOURCE.  
 6. 1500 PSI MASONRY COMPRESSION STRENGTH.  
 HALF STRESSES USED - NO SPECIAL INSPECTION REQD.

- NOTES:**
- CONCRETE BLOCK SHALL CONFORM TO UBC STD. 21-4. ORCO STD. PRECISION, SPLIT FACE, SLUMPED, OR WEDGELOCK BLOCK MAY BE USED
  - CONCRETE FOR FOOTING SHALL BE 1 PART CEMENT TO 2-1/2 PARTS SAND TO 3-1/2 PARTS GRAVEL WITHA MAXIMUM OF 1-1/2 GALLONS OF WATER PER SACK. PORTLAND CEMENT SHALL CONFORM TO ASTM C 150 TYPE III.  $F_c = 2500$  PSI
  - REINFORCING STEEL SHALL BE DEFORMED AND CONFORM TO ASTM A 615 GRADE 40 FOR #4 BARS AND SMALLER, GRADE 60 FOR #5 AND LARGER. PROVIDE 40 BAR DIAMETER LAP FOR GRADE 40 REBAR AND 48 BAR DIAMETER LAP FOR GRADE 60.
  - REBAR SHALL BE CENTERED IN THE CONCRETE BLOCK CELL IN WHICH IT IS LOCATED.
  - CONCRETE BLOCK SHALL BE LAYED IN A RUNNING BOND PATTERN WITH VERTICAL CONTINUITY OF THE CELLS UNO.
  - ALL BLOCK CELL CONTAINING VERTICAL REBAR SHALL BE SOLID GROUTED.
  - USE OBP TYPE S MORTAR PROPORTIONED USING UBC TABLE NO. 21-A. 1 PART CEMENT TO 1/2 PART LIME TO 4-1/2 PARTS DAMP, LOOSE SAND.
  - GROUT FOR CONCRETE BLOCK TO BE 1 PART CEMENT TO 3 PARTS SAND (GROUT MAY CONTAIN 2 PARTS 3/8" PEA GRAVEL IF WEATHER CONDITIONS ARE FAVORABLE AND BLOCK UNOBSTRUCTED CELL SIZE IS SUFFICIENT TO ALLOW GOOD GROUT FLOW). WATER SHALL BE ADDED TO PRODUCE GOOD GROUT FLOW WITHOUT SEGREGATION OF THE CONSITUENTS.
  - BLOCK STEM MAY BE WET-SET 1-1/2" INTO THE FOOTING WHILE THE CONCRETE IS PLASTIC. BLOCK STEM MAY BE PLACED TO EITHER EDGE OF THE TRENCH TYPE FOOTING.
  - FOOTING MUST BE POURED ON OR INTO UNDISTURBED NATURAL SOIL OR ON COMPACTED FILL WITH A MINIMUM COMPACTION OF 90%.
  - FIRST INSPECTION TO BE AFTER FOOTING TRENCHES ARE READY FOR CONCRETE AND ALL REQUIRED STEEL IS TIED IN PLACE. SECOND INSPECTION TO BE WHEN THE REQUIRED VERTICAL IS IN PLACE AND THE BLOCK WALL IS READY TO GROUT.
  - MAXIMUM CONTROL JOINT SPACING: 40' O/C OR 20' O/C IF THE WALL IS TO BE STUCCO COATED.

